

LOCALITY PLAN (N.T.S)

SPA LIGHTING DESIGN COMPLIANCE CERTIFICATE 

THIS LIGHTING DESIGN COMPLIES GENERALLY WITH THE NOMINATED CATEGORIES OF AS1158 FOR RATE 1 AND RATE 2 LUMINAIRES.

NAME: Michael Dayot TITLE: ENGINEER
RPEQ: 29435

LIGHTING CATEGORIES: CATEGORY: V5 FOR EAST POINT DRIVE
PR5 FOR SEAHAVEN COURT

LOCAL COUNCIL: MACKAY REGIONAL COUNCIL
LUMINAIRE UPCAST: 0 DEGREES UPCAST ANGLE
MAINTENANCE FACTOR: 0.75

THE DESIGN ASSUMES MAINTENANCE FACTORS OF 0.75 FOR MINOR ROAD LIGHTING AND 0.75 FOR MAJOR ROAD LIGHTING. THESE MAINTENANCE FACTORS ARE BASED ON THE FOLLOWING MAINTENANCE SCHEDULE, WHICH MIGHT NOT NECESSARILY BE ADOPTED BY ERGON.

- LAMPS SHALL BE REPLACED AT 36- MONTH INTERVALS.
- ALL THAT TIME, LUMINAIRES SHALL BE CLEANED, INSPECTED AND MAINTAINED.
- VEGETATION SHALL BE KEPT CLEAR OF STREET LIGHTS.
- INSPECTION PATROLS AND SPOT LAMP REPLACEMENT SHALL MAINTAIN SERVICE AVAILABILITY AT NO LESS THAN 95%.
- LUMINAIRES AND LAMPS SHALL BE REPLACED WITH EXACT EQUIVALENTS.

ALL LIGHTING CALCULATIONS ARE AVAILABLE UPON REQUEST.

FOR LIGHTING ARRANGEMENT, SPACINGS, MOUNTING HEIGHTS, OUTREACH DETAILS AND SIGNIFICANT ROAD FEATURES, REFER TO DRAWING.

WARNING: LIVE CABLES AND EXISTING SERVICES IN AREA. REFER TO NOTE 22

FOR CONSTRUCTION

| STN NO | SITE LABEL | POLE ALIGNMENT | POLE SETTING DEPTH | ACTION | CONSTRUCTION CLASS | CONSTRUCTION CODE | DRAWING NUMBER | POSITION ON POLE | REMARKS |
|--------|------------|----------------|--------------------|-----------------|----------------------|-------------------|----------------|------------------|--|
| 1 | SG852550 | | | INSTALL - ERGON | LV CABLE TERMINATION | LV CT PM11/240 | 5087 | | LV CABLE TERMINATION FOR STN 1 TO 4 |
| 2 | 11295318 | | | INSTALL - ERGON | PILLAR UPGRADE | LV PNU2-3/240 | 5074 | | ERGON ENERGY TO UPGRADE PILLAR TO THREE WAY IN THIS STAGE. COIL CABLE AT STN 2 FOR FINAL TERMINATION BY ERGON ENERGY.. |

ON COMPLETION, MARK UP THIS PRINT CLEARLY WITH ALL FINAL CHANGES AND RETURN TO PROJECT MANAGER

CHANGES: YES/NO

ELECTRICAL CONTRACTOR

NAME: _____

SIGNATURE: _____

DATE: _____

CIVIL CONTRACTOR

NAME: _____

SIGNATURE: _____

DATE: _____

| Code | Date | Description | Revised |
|------|----------|------------------|---------|
| A | 21/01/25 | FOR CONSTRUCTION | EB |

CLIENT: URBEX PTY LTD (BRISBANE)
PO BOX 197, WYNNUM, QLD 4178, Ph. (07) 3906 7444 Fax
CIVIL ENGINEER EMPOWER ENGINEERS (TOWNSVILLE)
PO BOX 6008, TOWNSVILLE, QLD 4810 Ph (07) 4750 7069 Fax

spa consulting engineers
Simon Perkins & Associates
Tel: (07) 4032 3311 or (07) 4728 3026
PO Box 664 North Cairns QLD 4870
Email Address - admin@spaconconsulting.com.au
A business unit of SPA Consulting Engineers (SLD) Pty Ltd ABN: 91 010 844 418

TRENCH SECTIONS-LEGEND

- ⊗ SPARE HV CONDUIT - EXISTING
- ⊗ SPARE HV CONDUIT - PLANNED
- CABLE - PLANNED
- CABLE - EXISTING
- /AB → CONDUITS - EXISTING
- /AB → CONDUITS - PLANNED

LEGEND

- ZERO LOT BOUNDARY
- 150mm HV DUCT
- 125mm HV DUCT
- 100mm LV DUCT
- LIGHTING DUCT
- 35mm sq ANNEALED BARE COPPER EARTH
- CABLE EXISTING
- CABLE PLANNED
- CABLE RECOVER
- EQUIPMENT EXISTING
- EQUIPMENT RECOVER
- EQUIPMENT PLANNED
- ⊠ SUBSTATION
- ⊠ RING MAIN UNIT
- ⊠ CROSS ROAD PILLAR
- ⊠ LINKING PILLAR
- ⊠ LIGHTING PIT
- ⊠ CABLE JOINT
- ⊠ N1, N2, N3, CIA1 & CIA2 PILLARS
- ⊠ DISTRIBUTION CABINET
- ⊠ STREETLIGHT
- ⊠ EARTH
- ⊠ HV/LV POLE
- ⊠ POLE MOUNTED TRANSFORMER
- HV POLE
- LV POLE

Drawing Title
EAST POINT STAGE 1D & 1R-2 UDC UG ELECTRICAL RETICULATION SITE PLAN & ERGON WORK SCHEDULE

Project Description
EAST POINT SUBDIVISION MACKAY, QLD 4740

| Date | DECEMBER 2024 |
|---------------------------|---------------------|
| Scale | 1:500@A1 |
| Drawn | MD |
| RPEQ Design Certification | Michael Dayot 29435 |
| Sheet | 1 OF 4 |
| ERGON Project Number | 1960039 |
| SPA Drawing Number | 4003-E01 |
| Revision | A |

CONDUIT SCHEMATIC

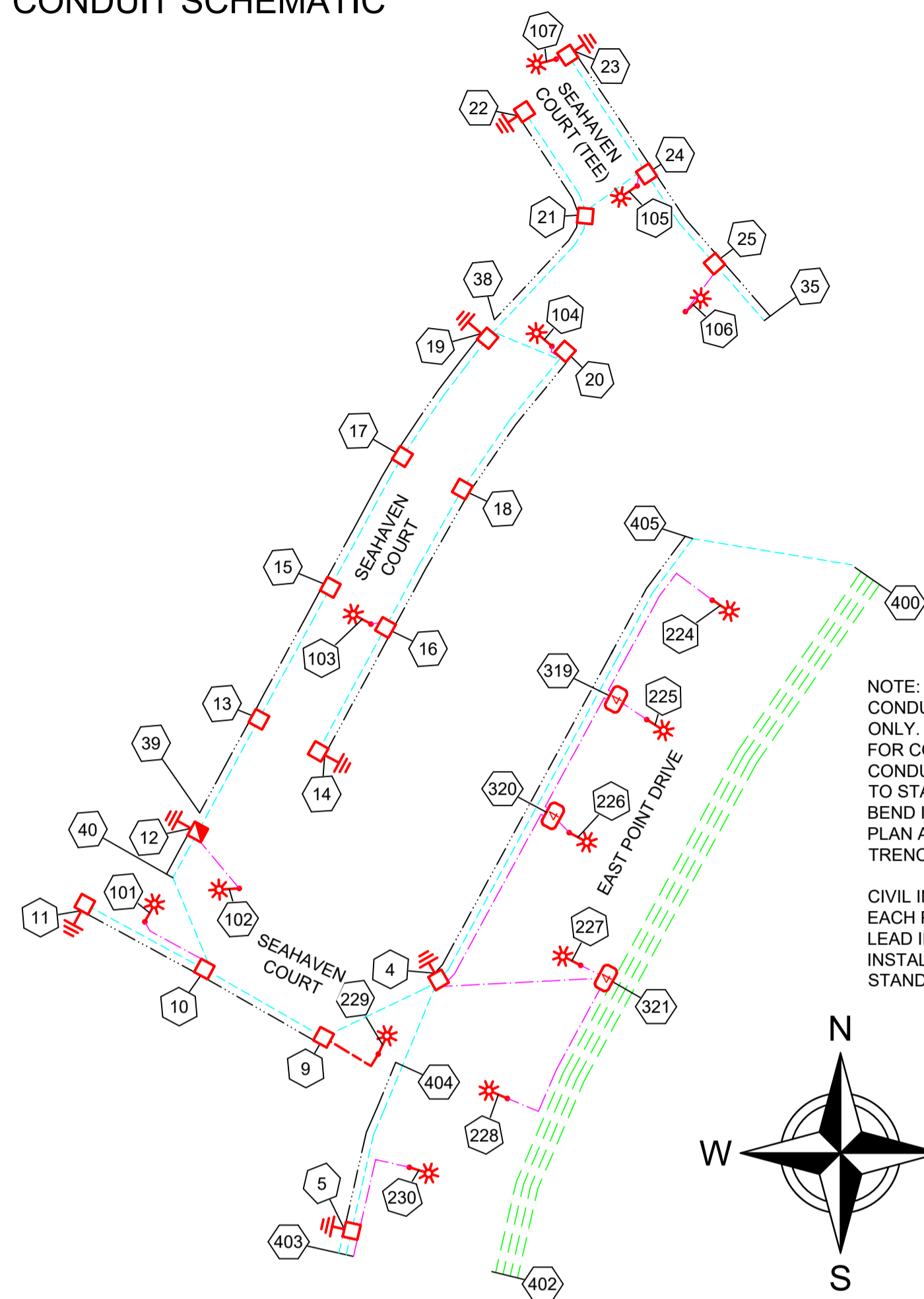

NOTE:
CONDUITS SHOWN ARE INDICATIVE ONLY. DO NOT USE AS REFERENCE FOR CONDUIT LAYING. REFER TO CONDUIT SCHEDULE FOR STATION TO STATION DETAILS AND CONDUIT BEND INFORMATION. REFER TO SITE PLAN AND WORKPLAN NOTES FOR TRENCH SECTION DETAILS.

CIVIL INSTALLERS NOTE:
EACH PILLAR REQUIRES 2 x 50mm LEAD IN CONDUITS. BENDS TO BE INSTALLED AS PER ERGON STANDARD DRAWINGS.

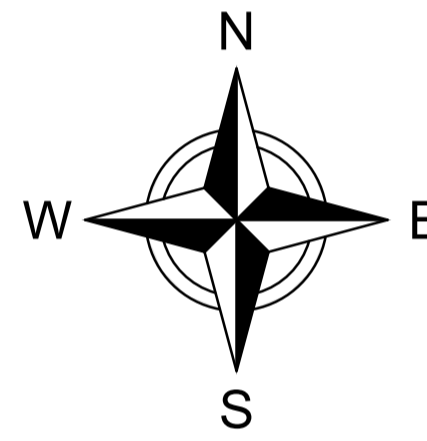

FOR CONSTRUCTION

ON COMPLETION, MARK UP THIS PRINT CLEARLY WITH ALL FINAL CHANGES AND RETURN TO PROJECT MANAGER

CHANGES: YES/NO

ELECTRICAL CONTRACTOR

NAME: _____
SIGNATURE: _____
DATE: _____

CIVIL CONTRACTOR

NAME: _____
SIGNATURE: _____
DATE: _____

| Rev Date | VERGE CONDUIT DUCTING SCHEDULE | | | | | | | |
|----------|--------------------------------|--------|-----------------|------------------------------|------------|-----------------------|-----------------------------------|--|
| 20-4-23 | STN FROM | STN TO | ACTION | CONSTRUCTION CODE | LENGTH (m) | No. of LENGTHS / DRUM | BENDS (Degrees/ Radius(mm) x No.) | Remarks |
| | 4 | 320 | INSTALL - CIVIL | C50H | 45 | 11.3 | 90/300x1 90/600x1 | |
| | 4 | 405 | INSTALL - CIVIL | 35mm2 ANNEALED BARE Cu EARTH | 102 | 0.4 | | COIL 2M OF CABLE AT STN 4 FOR FINAL CONNECTION BY ELECTRICAL CONTRACTOR. LEAVE IN BOTTOM OF TRENCH AT STN 406. |
| | 5 | 230 | INSTALL - CIVIL | C50H | 23 | 5.8 | 90/300x1 | |
| | 5 | 403 | INSTALL - CIVIL | C50H | 2 | 0.5 | 90/300x1 | CAP CONDUIT AT STN 403 |
| | 5 | 403 | INSTALL - CIVIL | C100L | 2 | 0.3 | 45/1200x1 | CAP CONDUIT AT STN 403 |
| | 5 | 403 | INSTALL - CIVIL | C100L | 2 | 0.3 | 45/1200x1 | CAP CONDUIT AT STN 403 |
| | 5 | 404 | INSTALL - CIVIL | 35mm2 ANNEALED BARE Cu EARTH | 35 | 0.1 | | COIL 2M OF CABLE AT STN 5 FOR FINAL CONNECTION BY ELECTRICAL CONTRACTOR. LEAVE IN BOTTOM OF TRENCH AT STN 404. |
| | 9 | 10 | INSTALL - CIVIL | C100L | 27 | 4.5 | 45/1200x2 | |
| | 9 | 229 | INSTALL - CIVIL | C50H | 14 | 3.5 | 90/300x2 90/600x1 | |
| | 10 | 11 | INSTALL - CIVIL | C100L | 27 | 4.5 | 45/1200x2 15/1830x4 | REFER TO NOTE 15 |
| | 10 | 101 | INSTALL - CIVIL | C50H | 15 | 3.8 | 90/300x2 90/600x1 | |
| | 11 | 9 | INSTALL - CIVIL | 35mm2 ANNEALED BARE Cu EARTH | 55 | 0.2 | | COIL 2M OF CABLE AT STN 11 FOR CONNECTION BY ELECTRICAL CONTRACTOR. LEAVE AT BOTTOM OF TRENCH AT STN 9. |
| | 12 | 40 | INSTALL - CIVIL | 35mm2 ANNEALED BARE Cu EARTH | 11 | 0.0 | | COIL 2M OF CABLE AT STN 12 FOR CONNECTION BY ELECTRICAL CONTRACTOR. LEAVE AT BOTTOM OF TRENCH AT STN 40. |
| | 13 | 12 | INSTALL - CIVIL | C100L | 25 | 4.2 | 45/1200x2 | |
| | 14 | 20 | INSTALL - CIVIL | 35mm2 ANNEALED BARE Cu EARTH | 93 | 0.4 | | COIL 2M OF CABLE AT STN 14 FOR CONNECTION BY ELECTRICAL CONTRACTOR. LEAVE AT BOTTOM OF TRENCH AT STN 20. |
| | 15 | 13 | INSTALL - CIVIL | C100L | 30 | 5.0 | 45/1200x2 | |
| | 16 | 14 | INSTALL - CIVIL | C100L | 28 | 4.7 | 45/1200x2 | |
| | 16 | 103 | INSTALL - CIVIL | C50H | 5 | 1.3 | 90/300x2 90/600x1 | BENDS ADDED TO AVOID NBN PIT |
| | 17 | 15 | INSTALL - CIVIL | C100L | 30 | 5.0 | 45/1200x2 | |
| | 18 | 16 | INSTALL - CIVIL | C100L | 32 | 5.3 | 45/1200x2 | |
| | 19 | 17 | INSTALL - CIVIL | C100L | 29 | 4.8 | 45/1200x2 15/1830x1 | |
| | 19 | 39 | INSTALL - CIVIL | 35mm2 ANNEALED BARE Cu EARTH | 112 | 0.4 | | COIL 2M OF CABLE AT STN 19 FOR CONNECTION BY ELECTRICAL CONTRACTOR. LEAVE AT BOTTOM OF TRENCH AT STN 39. |
| | 20 | 18 | INSTALL - CIVIL | C100L | 34 | 5.7 | 45/1200x2 15/1830x1 | |
| | 20 | 104 | INSTALL - CIVIL | C50H | 5 | 1.3 | 90/300x2 90/600x1 | BENDS ADDED TO AVOID NBN PIT. REFER TO NOTE 15 |
| | 21 | 19 | INSTALL - CIVIL | C100L | 32 | 5.3 | 45/1200x2 15/1830x2 | |
| | 21 | 22 | INSTALL - CIVIL | C100L | 24 | 4.0 | 45/1200x2 15/1830x1 | |
| | 22 | 38 | INSTALL - CIVIL | 35mm2 ANNEALED BARE Cu EARTH | 52 | 0.2 | | COIL 2M OF CABLE AT STN 22 FOR CONNECTION BY ELECTRICAL CONTRACTOR. LEAVE AT BOTTOM OF TRENCH AT STN 38. |
| | 23 | 35 | INSTALL - CIVIL | 35mm2 ANNEALED BARE Cu EARTH | 66 | 0.3 | | COIL 2M OF CABLE AT STN 23 FOR CONNECTION BY ELECTRICAL CONTRACTOR. LEAVE AT BOTTOM OF TRENCH AT STN 35. |
| | 23 | 107 | INSTALL - CIVIL | C50H | 4 | 1.0 | 90/300x2 | |
| | 24 | 23 | INSTALL - CIVIL | C100L | 29 | 4.8 | 45/1200x2 | REFER TO NOTE 15 |
| | 24 | 105 | INSTALL - CIVIL | C50H | 5 | 1.3 | 90/300x2 90/600x1 | BENDS ADDED TO AVOID NBN PIT |
| | 25 | 24 | INSTALL - CIVIL | C100L | 22 | 3.7 | 45/1200x2 15/1830x1 | |
| | 25 | 35 | INSTALL - CIVIL | C100L | 15 | 2.5 | 45/1200x1 | LOCATE EXISTING CAPPED CONDUIT AT STN 35 AND CONNECT TO NEW. |
| | 40 | 12 | INSTALL - CIVIL | C100L | 14 | 2.3 | 45/1200x1 | CONNECT TO CROSSING CONDUIT AT STN 40 |
| | 319 | 224 | INSTALL - CIVIL | C50H | 38 | 9.5 | 90/300x1 | |
| | 319 | 225 | INSTALL - CIVIL | C50H | 6 | 1.5 | 90/300x1 | |
| | 320 | 226 | INSTALL - CIVIL | C50H | 3 | 0.8 | 90/300x1 | |
| | 320 | 319 | INSTALL - CIVIL | C50H | 26 | 6.5 | | |
| | 321 | 227 | INSTALL - CIVIL | C50H | 6 | 1.5 | 90/300x1 | |
| | 321 | 228 | INSTALL - CIVIL | C50H | 37 | 9.3 | 90/300x1 | |
| | 400 | 402 | INSTALL - CIVIL | C150L | 159 | 26.5 | 15/1830x3 | LOCATE EXISTING CAPPED CONDUIT AT STN 400 AND CONNECT TO NEW. CAP CONDUIT AT STN 402. |
| | 400 | 402 | INSTALL - CIVIL | C150L | 159 | 26.5 | 15/1830x2 | LOCATE EXISTING CAPPED CONDUIT AT STN 400 AND CONNECT TO NEW. CAP CONDUIT AT STN 402. |
| | 400 | 402 | INSTALL - CIVIL | C150L | 159 | 26.5 | 15/1830x3 | LOCATE EXISTING CAPPED CONDUIT AT STN 400 AND CONNECT TO NEW. CAP CONDUIT AT STN 402. |
| | 400 | 402 | INSTALL - CIVIL | C150L | 159 | 26.5 | 15/1830x3 | LOCATE EXISTING CAPPED CONDUIT AT STN 400 AND CONNECT TO NEW. CAP CONDUIT AT STN 402. |
| | 404 | 5 | INSTALL - CIVIL | C100L | 28 | 4.7 | 45/1200x1 15/1830x1 | CONNECT TO CROSSING CONDUIT AT STN 404. |
| | 405 | 4 | INSTALL - CIVIL | C100L | 102 | 17.0 | 45/1200x1 15/1830x2 | CONNECT TO CROSSING CONDUIT AT STN 406. |

| Rev Date | CROSSING CONDUIT DUCTING SCHEDULE | | | | | | | |
|----------|-----------------------------------|--------|-----------------|-------------------|------------|-----------------------|-----------------------------------|--|
| 20-4-23 | STN FROM | STN TO | ACTION | CONSTRUCTION CODE | LENGTH (m) | No. of LENGTHS / DRUM | BENDS (Degrees/ Radius(mm) x No.) | Remarks |
| | 4 | 9 | INSTALL - CIVIL | C100L | 26 | 4.3 | 45/1200x2 15/1830x5 | |
| | 4 | 321 | INSTALL - CIVIL | C50H | 34 | 8.5 | 90/300x1 90/600x1 | |
| | 4 | 404 | INSTALL - CIVIL | C100L | 25 | 4.2 | 15/1830x4 | CONNECT TO VERGE CONDUIT AT STN 404 & 4 |
| | 10 | 40 | INSTALL - CIVIL | C100L | 17 | 2.8 | 45/1200x1 15/1830x4 | CONNECT TO VERGE CONDUIT AT STN 40. REFER TO NOTE 15 |
| | 12 | 102 | INSTALL - CIVIL | C50H | 15 | 3.8 | 90/300x2 90/600x1 | BENDS ADDED TO AVOID NBN PIT. REFER TO NOTE 15 |
| | 19 | 20 | INSTALL - CIVIL | C100L | 15 | 2.5 | 45/1200x2 45/1830x2 15/1830x4 | BENDS ADDED TO AVOID NBN PIT. REFER TO NOTE 15 & 16 |
| | 24 | 21 | INSTALL - CIVIL | C100L | 16 | 2.7 | 45/1200x2 15/1830x4 | BENDS ADDED TO AVOID NBN PIT. REFER TO NOTE 15 & 16 |
| | 25 | 106 | INSTALL - CIVIL | C50H | 12 | 3.0 | 90/300x2 90/600x1 | BENDS ADDED TO AVOID NBN PIT. REFER TO NOTE 15 |
| | 400 | 405 | INSTALL - CIVIL | C100L | 33 | 5.5 | 15/1830x4 | LOCATE EXISTING CAPPED CONDUIT AT STN 400 AND CONNECT TO NEW. CONNECT TO VERGE CONDUIT AT STN 405. REFER TO NOTE 15. |

WORKPLAN NOTES

- FOR STANDARD UNDERGROUND DUCT SECTIONS REFER TO UNDERGROUND CONSTRUCTION MANUAL DRAWING 5168.
- POLYMERIC COVER TO BE INSTALLED OVER CONDUITS OUTSIDE NORMAL ERGON ALIGNMENT AS PER ERGON DRAWING. 5022-1 AND 5124-1 & 2.
- STANDARD TRENCH ALIGNMENT IS 0.3 TO 0.9 METRES OFF PROPERTY ALIGNMENT SUBJECT TO LOCATION OF OTHER SERVICES. REFER TO UNDERGROUND CONSTRUCTION MANUAL DRAWING 5164 AND DRAWING 5228 FOR TRENCHES WITH NBNcO CONDUITS.
- STREETLIGHT POLE FOOTINGS SHALL BE LOCATED PERPENDICULAR TO THE KERB, AT THE PROLONGATION OF THE SIDE PROPERTY BOUNDARY, UNLESS DETAILED OTHERWISE. WHERE DIMENSIONS ARE SHOWN THEY TAKE PRECEDENCE OVER GRID COORDINATES.
- ALL CONDUITS SHALL BE CONTINUOUS UNLESS DETAILS OTHERWISE.
- FOR STANDARD UDC CONSTRUCTION PRACTICES REFER TO UNDERGROUND CONSTRUCTION MANUAL DRAWINGS 5022, 5085 AND 5124.
- MINOR STREETLIGHTS - THE DEVELOPER SHALL SUPPLY AND INSTALL STREETLIGHT BASES. FOUNDATION DEPTH IS 1200mm FOR MINOR STREETLIGHTS. REFER TO LIGHTING CONSTRUCTION MANUAL DRAWING 1-6-4-1 & 2.
- MAJOR STREETLIGHTS - THE DEVELOPER SHALL SUPPLY AND INSTALL STREETLIGHT BASES. FOUNDATION DEPTH IS 2250mm FOR MAJOR STREETLIGHTS. REFER TO LIGHTING CONSTRUCTION MANUAL DRAWING 1-5-6-1 & 2 FOR BPM FOOTINGS.
- THE LIGHTING DESIGN INCLUDES AN ALLOWANCE FOR CONSTRUCTION TOLERANCE OF LIGHT POLES SUCH THAT ANY STREETLIGHT CAN BE POSITIONED UP TO A MAXIMUM OF ±350mm LONGITUDINALLY FROM THE POSITION SHOWN AND UP TO 100mm MAXIMUM FURTHER AWAY FROM KERB EDGE, INCLUDING POLES WITH GRID COORDINATES, AND STILL MAINTAIN COMPLIANCE.
- CONFIRM ALL CONDUIT AND CABLE LENGTHS PRIOR TO INSTALLATION.
- WHERE SHOWN, 35mm sq ANNEALED BARE Cu EARTH SHALL BE INSTALLED AT BOTTOM OF TRENCH, IN NATURAL SOIL, BELOW BEDDING SAND, LOCATED A MINIMUM OF 50mm HORIZONTALLY TOWARDS PROPERTY BOUNDARY FROM CONDUITS (HV OR LV) INSTALLED ON PROPERTY BOUNDARY SIDE OF TRENCH. COIL 2m OF CABLE AT SPECIFIED STATIONS IN THE CONDUIT DUCTING SCHEDULE AND ALL REQUIRED JOINTS FOR CONNECTION BY ELECTRICAL CONTRACTOR. THE USE OF THE EARTH ROD CONNECTOR (U-BOLT, IIN 0719437) IS NOT ACCEPTABLE FOR CONDUCTOR / CABLE TO CONDUCTOR / CABLE CONNECTIONS. IN ADDITION PARALLEL GROOVE CLAMPS ARE NOT ACCEPTABLE FOR JOINING OR CONNECTING EARTHS BELOW GROUND LEVEL. ACCEPTABLE METHODS SHALL BE EITHER A CRIMP LINK OR A 'C' TYPE COMPRESSION CONNECTOR. CRIMP LINKS AND 'C' TYPE COMPRESSION CONNECTORS ARE AVAILABLE FROM ERGON ENERGY STORES IIN 0157746 AND IIN 2406222 RESPECTIVELY.
- IN ACCORDANCE WITH ELECTRICAL SAFETY ACT, A SAFETY OBSERVER MUST BE PRESENT AT ALL TIMES WHEN WORKING IN THE VICINITY OF ENERGISED CABLES. CONTACT ERGON ENERGY ON 131046.
- ELECTRONIC CABLE MARKERS (ECM'S) ARE TO BE SUPPLIED AND INSTALLED AT ENDS OF ALL SPARE CONDUITS INCLUDING (SPARE ROAD CROSSINGS, CONDUIT STUBS, FOR FUTURE STAGES, SPARE CONDUITS FOR FUTURE HV, ETC) AND AT ALL CABLE JOINTS. REFER TO ERGON STANDARD SPECIFICATIONS RSC07, RSC08, & RSM02.
- WHERE NOTED ON THE DESIGN, CONCRETE COVER SHALL BE INSTALLED ABOVE CONDUIT, WHERE CONDUIT BURIAL DEPTH IS LESS THAN THAT SPECIFIED IN UNDERGROUND CONSTRUCTION MANUAL DRAWING 5163. FOR FOOTPATHS REFER TO UNDERGROUND CONSTRUCTION MANUAL DRAWING 5016. FOR ROAD CROSSINGS REFER TO UNDERGROUND CONSTRUCTION MANUAL DRAWING 5017.
- EXTRA CONDUIT BENDS SHALL BE INSTALLED TO ACHIEVE INCREASED BURIAL DEPTH AT ROAD CROSSINGS. REFER TO UNDERGROUND CONSTRUCTION MANUAL DRAWING 5022.
- ALL CONTRACTORS MUST CARRY OUT A DIAL BEFORE YOU DIG ENQUIRY BEFORE COMMENCING ANY EXCAVATION.
- WHERE NOTED ON THE DESIGN, ELECTRICAL CONDUITS SHALL BE INSTALLED UNDERNEATH STORMWATER PIPES WHERE CLASHES OCCUR. SEPARATION FROM BOTTOM OF STORMWATER PIPE TO TOP OF ERGON CONDUIT SHALL BE NO LESS THAN 300mm.
- INSTALL PILLAR OFFSET IN ACCORDANCE WITH ERGON DRAWING 5196-2 & DETAIL A.
- CONTRACTOR TO ENSURE MACKAY REGIONAL COUNCIL POLICY 063 AND 15.05 ARE ADHERED TO WITH RESPECT TO CLEARANCES BETWEEN ELECTRICAL OR COMMUNICATIONS INFRASTRUCTURE AND COUNCIL SERVICES.
- CONTRACTOR TO SUPPLY AND INSTALL ENGRAVED LABEL LOCATED ON LIGHTING TERMINAL STATING "LIGHT FED FROM PILLAR ASSET NUMBER _____"
- WHERE REQUIRED CONTRACTOR TO INSTALL JOINT AT STN 401 WITH A 2m x 6m SAND PIT FOR ACCESS. CONTRACTOR TO MONITOR PULLING TENSIONS TO DETERMINE IF JOINT REQUIRED. ADDITIONAL LUBRICATION PITS MAYBE REQUIRED ON SITE FOR THESE PULLS. ELECTRICAL CONTRACTOR TO CONFIRM WITH CIVIL CONTRACTOR AT PRESTART MEETING WHERE AND IF SAND PITS ARE REQUIRED.
- WARNING:** LIVE CABLES AND EXISTING SERVICES IN AREA. CONTRACTOR TO USE POT HOLING, HYDRO-VAC EXCAVATION AND CABLE LOCATION WHEN INSTALLING NEW INFRASTRUCTURE.
- CONTRACTOR TO SUPPLY AND INSTALL LUMINAIRES (SLED GL 0250 A2.2 & SLEDPH0509A2.2). LUMINAIRES TO BE DIRECTLY PURCHASED FROM ANDREW CJHASE ON 0411258509 (SIGNIFY) FOR THE PHILIPS LUMINAIRES & IAN BOLLAM ON 0400385979 (SYLVANIA) FOR THE GERALD LUMINAIRES.

| | |
|--|------------------------------|
| CLIENT: URBEX PTY LTD (BRISBANE) | |
| pO BOX 197 WYNNUM, QLD 4178. Ph. (07) 3906 7444 Fax | |
| CIVIL ENGINEER EMPOWER ENGINEERS (TOWNSVILLE) | |
| A | 21/01/25 FOR CONSTRUCTION EB |
| PO BOX 6008, TOWNSVILLE, QLD 4810 Ph. (07) 4750 7069 Fax | |



Tel: (07) 4032 3311 or (07) 4728 3026
PO Box 664 North Cairns QLD 4870
Email Address - admin@spaconsulting.com.au
A business unit of SPA Consulting Engineers (SLE) Pty Ltd ABN 91 010 844 418

| TRENCH SECTIONS-LEGEND | |
|------------------------|-----------------------------|
| ⊗ | SPARE HV CONDUIT - EXISTING |
| ⊗ | SPARE HV CONDUIT - PLANNED |
| ● | CABLE - PLANNED |
| ● | CABLE - EXISTING |
| ○AB | CONDUITS - EXISTING |
| ○AB | CONDUITS - PLANNED |

| LEGEND | |
|--------|------------------------------------|
| ◆◆◆ | ZERO LOT BOUNDARY |
| — | 150mm HV DUCT |
| — | 125mm HV DUCT |
| — | 100mm LV DUCT |
| — | LIGHTING DUCT |
| — | 35mm sq ANNEALED BARE COPPER EARTH |
| --- | CABLE EXISTING |
| --- | CABLE PLANNED |
| --- | CABLE RECOVER |
| --- | EQUIPMENT EXISTING |
| --- | EQUIPMENT RECOVER |
| --- | EQUIPMENT PLANNED |

| | |
|---|---------------------------------|
| ⊠ | SUBSTATION |
| ⊠ | RING MAIN UNIT |
| ⊠ | CROSS ROAD PILLAR |
| ⊠ | LINKING PILLAR |
| ⊠ | LIGHTING PIT |
| ⊠ | CABLE JOINT |
| □ | N1, N2, N3, CIA1 & CIA2 PILLARS |
| □ | DISTRIBUTION CABINET |
| * | STREETLIGHT |
| — | EARTH |
| ○ | HV POLE |
| ○ | HV/LV POLE |
| ● | LV POLE |
| ⊠ | POLE MOUNTED TRANSFORMER |

| | | | |
|--|--|----------------------|--------------------|
| Drawing Title | | Date | DECEMBER 2024 |
| EAST POINT STAGE 1D & 1R-2 UDC UG ELECTRICAL RETICULATION CONDUIT SCHEMATIC & SCHEDULE AND NOTES | | Scale | NTS |
| RPEQ Design Certification Michael Dayot 29435 | | Drawn | EB |
| Sheet | | 2 OF 4 | |
| Project Description | | ERGON Project Number | SPA Drawing Number |
| EAST POINT SUBDIVISION MACKAY, QLD 4740 | | 1960039 | 4003-E02 |
| | | Revision | A |

LV SCHEMATIC

CONTRACTOR TO INSTALL LABELS AS PER BELOW

| NEW LINK PILLAR | | | | |
|--------------------------|------------|--------------|---------------------|---|
| LOCATION: SEAHAVEN COURT | | | STATION: LP12506059 | |
| CIRCUIT No. | LABEL SIZE | LABEL COLOUR | LETTER SIZE | LABEL INFORMATION |
| 1 (LHS) | 150x50 | WB | 5 | TO EAST POINT DR SG852550 FS3 / 12506048 / TO SEAHAVEN COURT 12506058 & SERVICES |
| 2 (RHS) | 150x50 | WB | 5 | TO EAST POINT DR SG852550 FS2 / LP11295323 / TO SEAHAVEN COURT(TEE) 12506070 / 12506069 / TO SEAHAVEN COURT 12506061 & SERVICES |

MATERIAL: GRAVOPLY II (1.5mm) or similar

| LV PULLING TENSION CALCULATED AND RECORDED | | | |
|--|------------|------------|----------|
| STATION FROM | STATION TO | CALCULATED | RECORDED |
| 4 | 15 | 4,275.42 N | N |

LEGEND:

- 240C4-LV CABLE
- 16CU4-LV CABLE
- 4CU2-SL CABLE
- 16CU2-SL CABLE
- EXISTING CABLE

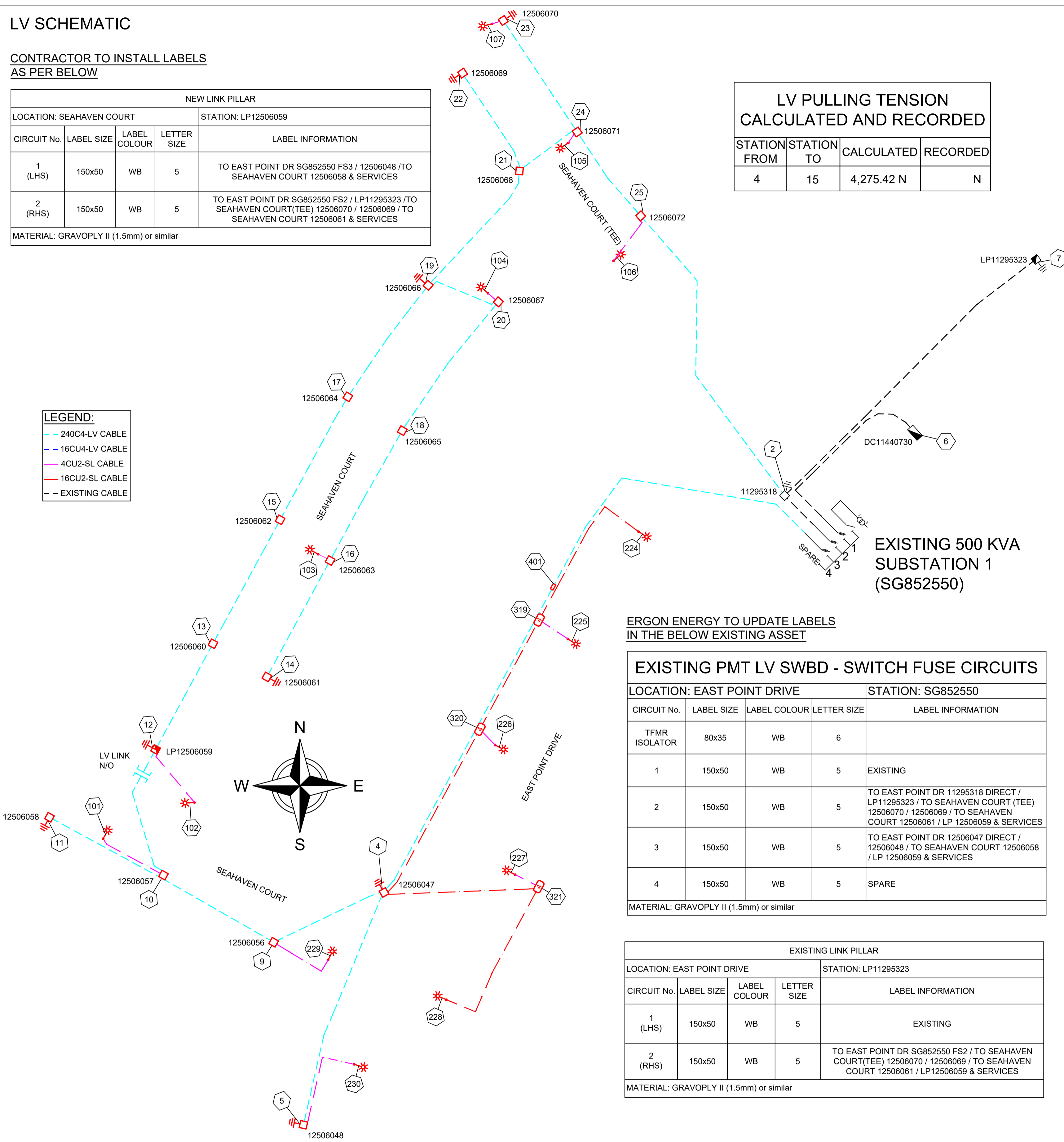

ERGON ENERGY TO UPDATE LABELS IN THE BELOW EXISTING ASSET

| EXISTING PMT LV SWBD - SWITCH FUSE CIRCUITS | | | | |
|---|------------|--------------|-------------------|---|
| LOCATION: EAST POINT DRIVE | | | STATION: SG852550 | |
| CIRCUIT No. | LABEL SIZE | LABEL COLOUR | LETTER SIZE | LABEL INFORMATION |
| TFMR ISOLATOR | 80x35 | WB | 6 | |
| 1 | 150x50 | WB | 5 | EXISTING |
| 2 | 150x50 | WB | 5 | TO EAST POINT DR 11295318 DIRECT / LP11295323 / TO SEAHAVEN COURT (TEE) 12506070 / 12506069 / TO SEAHAVEN COURT 12506061 / LP 12506059 & SERVICES |
| 3 | 150x50 | WB | 5 | TO EAST POINT DR 12506047 DIRECT / 12506048 / TO SEAHAVEN COURT 12506058 / LP 12506059 & SERVICES |
| 4 | 150x50 | WB | 5 | SPARE |

MATERIAL: GRAVOPLY II (1.5mm) or similar

| EXISTING LINK PILLAR | | | | |
|----------------------------|------------|--------------|---------------------|---|
| LOCATION: EAST POINT DRIVE | | | STATION: LP11295323 | |
| CIRCUIT No. | LABEL SIZE | LABEL COLOUR | LETTER SIZE | LABEL INFORMATION |
| 1 (LHS) | 150x50 | WB | 5 | EXISTING |
| 2 (RHS) | 150x50 | WB | 5 | TO EAST POINT DR SG852550 FS2 / TO SEAHAVEN COURT(TEE) 12506070 / 12506069 / TO SEAHAVEN COURT 12506061 / LP12506059 & SERVICES |

MATERIAL: GRAVOPLY II (1.5mm) or similar

| UNDERGROUND CABLE SCHEDULE | | | | | | | |
|----------------------------|--------|---------|---------|-------------------|--------------|--------------|--|
| STN FROM | STN TO | ACTION | VOLTAGE | CONSTRUCTION CODE | ROUTE LENGTH | CABLE LENGTH | REMARKS |
| 1 | 4 | INSTALL | 415V | LV-240C4/673 | 139 | 151 | COIL CABLE AT STN 1 FOR FINAL TERMINATION BY ERGON ENERGY. REFER TO NOTE 21. |
| 2 | 25 | INSTALL | 415V | LV-240C4/673 | 70 | 74 | COIL CABLE AT STN 2 FOR FINAL TERMINATION BY ERGON ENERGY. |
| 4 | 5 | INSTALL | 415V | LV-240C4/673 | 54 | 58 | |
| 4 | 9 | INSTALL | 415V | LV-240C4/673 | 26 | 30 | |
| 4 | 320 | INSTALL | 240V | LVI-16CU2NS/1672 | 45 | 49 | |
| 4 | 321 | INSTALL | 240V | LVI-16CU2NS/1672 | 34 | 38 | |
| 5 | 230 | INSTALL | 240V | LVI-4CU2NS/1671 | 23 | 28 | |
| 9 | 10 | INSTALL | 415V | LV-240C4/673 | 27 | 31 | |
| 9 | 229 | INSTALL | 240V | LVI-4CU2NS/1671 | 14 | 19 | |
| 10 | 11 | INSTALL | 415V | LV-240C4/673 | 27 | 31 | |
| 10 | 12 | INSTALL | 415V | LV-240C4/673 | 31 | 35 | LV LINK |
| 10 | 101 | INSTALL | 240V | LVI-4CU2NS/1671 | 15 | 20 | |
| 12 | 102 | INSTALL | 240V | LVI-4CU2NS/1671 | 15 | 20 | |
| 13 | 12 | INSTALL | 415V | LV-240C4/673 | 25 | 29 | |
| 15 | 13 | INSTALL | 415V | LV-240C4/673 | 30 | 34 | |
| 16 | 14 | INSTALL | 415V | LV-240C4/673 | 28 | 32 | |
| 16 | 103 | INSTALL | 240V | LVI-4CU2NS/1671 | 5 | 10 | |
| 17 | 15 | INSTALL | 415V | LV-240C4/673 | 30 | 34 | |
| 18 | 16 | INSTALL | 415V | LV-240C4/673 | 32 | 36 | |
| 19 | 17 | INSTALL | 415V | LV-240C4/673 | 29 | 33 | |
| 19 | 20 | INSTALL | 415V | LV-240C4/673 | 15 | 19 | |
| 20 | 18 | INSTALL | 415V | LV-240C4/673 | 34 | 38 | |
| 20 | 104 | INSTALL | 240V | LVI-4CU2NS/1671 | 5 | 10 | |
| 21 | 19 | INSTALL | 415V | LV-240C4/673 | 32 | 36 | |
| 21 | 22 | INSTALL | 415V | LV-240C4/673 | 24 | 28 | |
| 23 | 107 | INSTALL | 240V | LVI-4CU2NS/1671 | 4 | 9 | |
| 24 | 21 | INSTALL | 415V | LV-240C4/673 | 16 | 20 | |
| 24 | 23 | INSTALL | 415V | LV-240C4/673 | 29 | 33 | |
| 24 | 105 | INSTALL | 240V | LVI-4CU2NS/1671 | 5 | 10 | |
| 25 | 24 | INSTALL | 415V | LV-240C4/673 | 22 | 26 | |
| 25 | 106 | INSTALL | 240V | LVI-4CU2NS/1671 | 12 | 17 | |
| 319 | 224 | INSTALL | 240V | LVI-16CU2NS/1672 | 38 | 43 | |
| 319 | 225 | INSTALL | 240V | LVI-4CU2NS/1671 | 6 | 11 | |
| 320 | 226 | INSTALL | 240V | LVI-4CU2NS/1671 | 3 | 8 | |
| 320 | 319 | INSTALL | 240V | LVI-16CU2NS/1672 | 26 | 30 | |
| 321 | 227 | INSTALL | 240V | LVI-4CU2NS/1671 | 6 | 11 | |
| 321 | 228 | INSTALL | 240V | LVI-16CU2NS/1672 | 37 | 42 | |

| PUBLIC LIGHTING SCHEDULE | | | | | | | |
|--------------------------|------------|----------|-------------------|--------|--------------|---------------------|-----------------------|
| STN NO | SITE LABEL | ACTION | CONSTRUCTION CODE | RATE | TARIFF OWNER | MOUNTING HEIGHT (m) | REMARKS |
| 101 | 12506073 | INSTALL | SLED GL 0250 A2.2 | RATE 2 | MRC | 7.5 | REFER TO BELOW NOTES. |
| 102 | 12506074 | INSTALL | SLED GL 0250 A2.2 | RATE 2 | MRC | 7.5 | REFER TO BELOW NOTES. |
| 103 | 12506075 | INSTALL | SLED GL 0250 A2.2 | RATE 2 | MRC | 7.5 | REFER TO BELOW NOTES. |
| 104 | 12506076 | INSTALL | SLED GL 0250 A2.2 | RATE 2 | MRC | 7.5 | REFER TO BELOW NOTES. |
| 105 | 12506077 | INSTALL | SLED GL 0250 A2.2 | RATE 2 | MRC | 7.5 | REFER TO BELOW NOTES. |
| 106 | 12506078 | INSTALL | SLED GL 0250 A2.2 | RATE 2 | MRC | 7.5 | REFER TO BELOW NOTES. |
| 107 | 12506079 | INSTALL | SLED GL 0250 A2.2 | RATE 2 | MRC | 7.5 | REFER TO BELOW NOTES. |
| 217 | 11295329 | EXISTING | | | | | |
| 224 | 12506049 | INSTALL | SLEDPH0509A2.2 | RATE 2 | MRC | 9 | REFER BELOW NOTES |
| 225 | 12506050 | INSTALL | SLEDPH0509A2.2 | RATE 2 | MRC | 9 | REFER BELOW NOTES |
| 226 | 12506051 | INSTALL | SLEDPH0509A2.2 | RATE 2 | MRC | 9 | REFER BELOW NOTES |
| 227 | 12506052 | INSTALL | SLEDPH0509A2.2 | RATE 2 | MRC | 9 | REFER BELOW NOTES |
| 228 | 12506053 | INSTALL | SLEDPH0509A2.2 | RATE 2 | MRC | 9 | REFER BELOW NOTES |
| 229 | 12715212 | INSTALL | SLEDPH0509A2.2 | RATE 2 | MRC | 9 | REFER BELOW NOTES |
| 230 | 12715213 | INSTALL | SLEDPH0509A2.2 | RATE 2 | MRC | 9 | REFER BELOW NOTES |

*SLEDPH0509A2.2 IS PHILIPS 50W ROADFLAIR 2.2K AEROSCREEN LUMINAIRE COMPLETE WITH A -5 DEGREE ADAPTOR. REFER TO NOTE 23.

*SLEDGL0250A2.2 IS A GERARD LIGHTING STREET LD MKIII 25W 2.2K AEROSCREEN LUMINAIRE. REFER TO NOTE 23.

FOR CONSTRUCTION

ON COMPLETION, MARK UP THIS PRINT CLEARLY WITH ALL FINAL CHANGES AND RETURN TO PROJECT MANAGER

CHANGES: YES/NO

ELECTRICAL CONTRACTOR

NAME: _____

SIGNATURE: _____

DATE: _____

CIVIL CONTRACTOR

NAME: _____

SIGNATURE: _____

DATE: _____

| | |
|---|--|
| CLIENT: URBEX PTY LTD (BRISBANE) | PO BOX 197, WYNNUM, QLD 4178. Ph. (07) 3906 7444 Fax |
| CIVIL ENGINEER EMPOWER ENGINEERS (TOWNSVILLE) | PO BOX 6008, TOWNSVILLE, QLD 4810 Ph. (07) 4750 7069 Fax |



TRENCH SECTIONS-LEGEND

- SPARE HV CONDUIT - EXISTING
- SPARE HV CONDUIT - PLANNED
- CABLE - PLANNED
- CABLE - EXISTING
- CONDUITS - EXISTING
- CONDUITS - PLANNED

LEGEND

- ZERO LOT BOUNDARY
- 150mm HV DUCT
- 125mm HV DUCT
- 100mm LV DUCT
- LIGHTING DUCT
- 35mm sq ANNEALED BARE COPPER EARTH
- CABLE EXISTING
- CABLE PLANNED
- CABLE RECOVER
- EQUIPMENT EXISTING
- EQUIPMENT RECOVER
- EQUIPMENT PLANNED
- SUBSTATION
- RING MAIN UNIT
- CROSS ROAD PILLAR
- LINKING PILLAR
- LIGHTING PIT
- CABLE JOINT
- N1, N2, N3, CIA1 & CIA2 PILLARS
- DISTRIBUTION CABINET
- STREETLIGHT
- EARTH
- HV/LV POLE
- POLE MOUNTED TRANSFORMER

| | | |
|--|---|--------------------|
| Drawing Title | Date | DECEMBER 2024 |
| EAST POINT STAGE 1 D & 1R-2 UDC UG ELECTRICAL RETICULATION LV SCHEMATIC & LABELS, CABLE AND LIGHTING SCHEDULES | Scale | NTS |
| | Drawn | EB |
| | RPEQ Design Certification Michael Dayot 29435 | |
| | Sheet | 3 OF 4 |
| Project Description | ERGON Project Number | SPA Drawing Number |
| EAST POINT SUBDIVISION MACKAY, QLD 4740 | 1960039 | 4003-E03 |
| | Revision | A |

| STN NO | SITE LABEL | POLE ALIGNMENT | POLE SETTING DEPTH | ACTION | CONSTRUCTION CLASS | CONSTRUCTION CODE | DRAWING NUMBER | POSITION ON POLE | REMARKS |
|--------|------------|----------------|--------------------|-----------------|------------------------------|-------------------|----------------|------------------|---|
| 1 | SG852550 | | | EXISTING | EARTH | | | | |
| 1 | SG852550 | | | INSTALL - ERGON | LV CABLE TERMINATION | LV CT PM11/240 | 5087 | | LV CABLE TERMINATION FOR STN 1 TO 4 |
| 1 | SG852550 | | | EXISTING | SUBSTATION INC HV SWITCHGEAR | | | | |
| 2 | 11295318 | | | EXISTING | EARTH | | | | |
| 2 | 11295318 | | | EXISTING | PILLAR | | | | |
| 2 | 11295318 | | | INSTALL - ERGON | PILLAR UPGRADE | LV PNU2-3/240 | 5074 | | ERGON ENERGY TO UPGRADE PILLAR TO THREE WAY IN THIS STAGE. COIL CABLE AT STN 2 FOR FINAL TERMINATION BY ERGON ENERGY... |
| 4 | 12506047 | | | INSTALL | EARTH | E MEN/PIL | 5085 | | |
| 4 | 12506047 | | | INSTALL | PILLAR | LV PN3/6S/240 | 5027 | | ADDITIONAL 32AMP FUSE REQUIRED. |
| 5 | 12506048 | | | INSTALL | EARTH | E MEN/PIL | 5085 | | |
| 5 | 12506048 | | | INSTALL | PILLAR | LV PN1/6S/240 | 5025 | | INSTALL PILLAR OFFSET TOWARDS LOT BOUNDARY AS SHOWN. REFER TO NOTE 18. TO BE UPGRADED TO THREE WAY IN FUTURE. |
| 6 | DC11440730 | | | EXISTING | DISTRIBUTION CABINET | | | | |
| 7 | LP11295323 | | | EXISTING | EARTH | | | | |
| 7 | LP11295323 | | | EXISTING | PILLAR | | | | |
| 9 | 12506056 | | | INSTALL | PILLAR | LV PN2/6S/240 | 5026 | | |
| 10 | 12506057 | | | INSTALL | PILLAR | LV PN3/6S/240 | 5027 | | |
| 11 | 12506058 | | | INSTALL | EARTH | E MEN/PIL | 5085 | | |
| 11 | 12506058 | | | INSTALL | PILLAR | LV PN1/6/240 | 5025 | | |
| 12 | LP12506059 | | | INSTALL | EARTH | E MEN/PIL | 5085 | | |
| 12 | LP12506059 | | | INSTALL | PILLAR | LV PL2/6S/240 | 5042 | | INSTALL PILLAR OFFSET TOWARDS LOT 92. REFER TO NOTE 18 |
| 13 | 12506060 | | | INSTALL | PILLAR | LV PN2/6/240 | 5026 | | |
| 14 | 12506061 | | | INSTALL | EARTH | E MEN/PIL | 5085 | | |
| 14 | 12506061 | | | INSTALL | PILLAR | LV PN1/6/240 | 5025 | | INSTALL PILLAR OFFSET TOWARDS LOT 85. REFER TO NOTE 18 |
| 15 | 12506062 | | | INSTALL | PILLAR | LV PN2/6/240 | 5026 | | |
| 16 | 12506063 | | | INSTALL | PILLAR | LV PN2/6S/240 | 5026 | | |
| 17 | 12506064 | | | INSTALL | PILLAR | LV PN2/6/240 | 5026 | | |
| 18 | 12506065 | | | INSTALL | PILLAR | LV PN2/6/240 | 5026 | | INSTALL PILLAR OFFSET TOWARDS LOT 81. REFER TO NOTE 18 |
| 19 | 12506066 | | | INSTALL | EARTH | E MEN/PIL | 5085 | | |
| 19 | 12506066 | | | INSTALL | PILLAR | LV PN3/6/240 | 5027 | | INSTALL PILLAR OFFSET TOWARDS LOT 100. REFER TO NOTE 18 |
| 20 | 12506067 | | | INSTALL | PILLAR | LV PN2/6S/240 | 5026 | | |
| 21 | 12506068 | | | INSTALL | PILLAR | LV PN3/6/240 | 5027 | | INSTALL PILLAR OFFSET TOWARDS LOT 102. REFER TO NOTE 18 |
| 22 | 12506069 | | | INSTALL | EARTH | E MEN/PIL | 5085 | | |
| 22 | 12506069 | | | INSTALL | PILLAR | LV PN1/6/240 | 5025 | | INSTALL PILLAR OFFSET TOWARDS LOT 103. REFER TO NOTE 18 |
| 23 | 12506070 | | | INSTALL | EARTH | E MEN/PIL | 5085 | | |
| 23 | 12506070 | | | INSTALL | PILLAR | LV PN1/6S/240 | 5025 | | INSTALL PILLAR OFFSET TOWARDS LOT 73. REFER TO NOTE 18 |
| 24 | 12506071 | | | INSTALL | PILLAR | LV PN3/6S/240 | 5027 | | INSTALL PILLAR OFFSET TOWARDS LOT 74. REFER TO NOTE 18 |
| 25 | 12506072 | | | INSTALL | PILLAR | LV PN2/6S/240 | 5026 | | |
| 101 | 12506073 | 0.9M FROM IOK | | INSTALL | POLE | SL BPM/75/1 15 CI | 1-6-4-1 & 2 | | REFER TO NOTE 20 |
| 102 | 12506074 | 0.9M FROM IOK | | INSTALL | POLE | SL BPM/75/1 15 CI | 1-6-4-1 & 2 | | INSTALL LIGHT POLE FROM PROPERTY BOUNDARY TRUNCATION AS SHOWN. REFER TO NOTE 20 |
| 103 | 12506075 | 0.9M FROM IOK | | INSTALL | POLE | SL BPM/75/1 15 CI | 1-6-4-1 & 2 | | |
| 104 | 12506076 | 0.9M FROM IOK | | INSTALL | POLE | SL BPM/75/1 15 CI | 1-6-4-1 & 2 | | |
| 105 | 12506077 | 0.9M FROM IOK | | INSTALL | POLE | SL BPM/75/1 15 CI | 1-6-4-1 & 2 | | |
| 106 | 12506078 | 0.9M FROM IOK | | INSTALL | POLE | SL BPM/75/1 15 CI | 1-6-4-1 & 2 | | INSTALL LIGHT POLE OFFSET 2.5M FROM PROPERTY BOUNDARY TRUNCATION AS SHOWN. REFER TO NOTE 20 |
| 107 | 12506079 | 0.9M FROM IOK | | INSTALL | POLE | SL BPM/75/1 15 CI | 1-6-4-1 & 2 | | LOCATE LIGHT FOUNDATION NO CLOSER THAN 1.3M FROM EDGE OF BITUMEN. |

| STN NO | SITE LABEL | POLE ALIGNMENT | POLE SETTING DEPTH | ACTION | CONSTRUCTION CLASS | CONSTRUCTION CODE | DRAWING NUMBER | POSITION ON POLE | REMARKS |
|--------|------------|----------------|--------------------|----------|--------------------|-----------------------|----------------|------------------|--|
| 217 | 11295329 | | | EXISTING | POLE | | | | |
| 224 | 12506049 | 0.9M FROM IOK | | INSTALL | POLE | SL BPM/90/1 30/UG C11 | 1-5-6-1 & 2 | | OFFSET 5.79M FROM PROPERTY BOUNDARY. LOCATE STREETLIGHT FOUNDATION NO CLOSER THAN 1.3M FROM EDGE OF BITUMEN. REFER TO NOTE 20. |
| 225 | 12506050 | 0.9M FROM IOK | | INSTALL | POLE | SL BPM/90/1 30/UG C11 | 1-5-6-1 & 2 | | OFFSET 4.84M FROM PROPERTY BOUNDARY. LOCATE STREETLIGHT FOUNDATION 1.3M FROM EDGE OF BITUMEN. REFER TO NOTE 20 |
| 226 | 12506051 | 0.9M FROM IOK | | INSTALL | POLE | SL BPM/90/1 30/UG C11 | 1-5-6-1 & 2 | | OFFSET 2.81M FROM PROPERTY BOUNDARY. LOCATE STREETLIGHT FOUNDATION 0.9M FROM FACE OF KERB. REFER TO NOTE 20 |
| 227 | 12506052 | 0.9M FROM IOK | | INSTALL | POLE | SL BPM/90/1 30/UG C11 | 1-5-6-1 & 2 | | OFFSET 20.66M FROM PROPERTY TRUNCATION. LOCATE STREETLIGHT FOUNDATION 0.9M FROM FACE OF KERB. REFER TO NOTE 20. |
| 228 | 12506053 | 0.9M FROM IOK | | INSTALL | POLE | SL BPM/90/1 30/UG C11 | 1-5-6-1 & 2 | | OFFSET LIGHT 9.26M FROM PROPERTY TRUNCATION. REFER TO NOTE 20. |
| 229 | 12715212 | 0.9M FROM IOK | | INSTALL | POLE | SL BPM/90/1 30/UG C11 | 1-5-6-1 & 2 | | REFER TO NOTE 20. |
| 230 | 12715213 | 0.9M FROM IOK | | INSTALL | POLE | SL BPM/90/1 30/UG C11 | 1-5-6-1 & 2 | | OFFSET 4.75M FROM PROPERTY BOUNDARY PEG. REFER TO NOTE 20. |
| 309 | 11295341 | | | EXISTING | TYPE 4 LOOP PIT | | | | |
| 319 | 12715214 | | | INSTALL | TYPE 4 LOOP PIT | SUG SLL PIT | 1-4-9-1 | | REFER TO NOTE 23. |
| 320 | 12715215 | | | INSTALL | TYPE 4 LOOP PIT | SUG SLL PIT | 1-4-9-1 | | REFER TO NOTE 23. |
| 321 | 12715216 | | | INSTALL | TYPE 4 LOOP PIT | SUG SLL PIT | 1-4-9-1 | | REFER TO NOTE 23. |
| 401 | | | | INSTALL | CABLE JOINT | LV-CJS240C4 | 5073 | | REFER TO NOTE 21 & 22. |

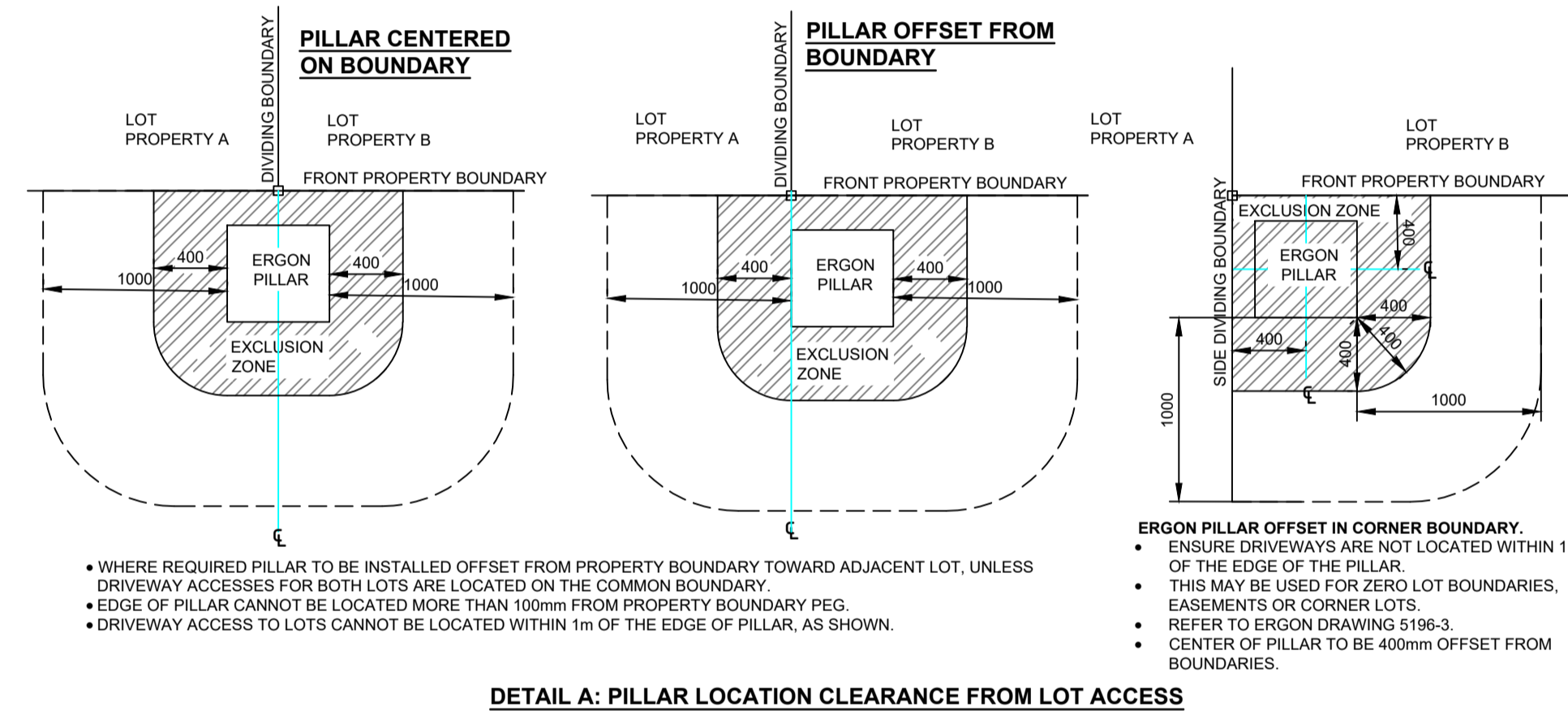

FOR CONSTRUCTION

ON COMPLETION, MARK UP THIS PRINT CLEARLY WITH ALL FINAL CHANGES AND RETURN TO PROJECT MANAGER

CHANGES: YES/NO

ELECTRICAL CONTRACTOR

NAME: _____

SIGNATURE: _____

DATE: _____

CIVIL CONTRACTOR

NAME: _____

SIGNATURE: _____

DATE: _____

| | | | | | | | | | | | | | | | |
|---|--|--|---|--|---|--|---|--|---|--|--|--------------------|----------|---------------|----------|
| CLIENT: URBEX PTY LTD (BRISBANE) | | <p>Simon Perkins & Associates</p> <p>Tel: (07) 4032 3311 or (07) 4728 3026</p> <p>PO Box 664 North Cairns QLD 4870</p> <p>Email Address - admin@spaconconsulting.com.au</p> <p>A business unit of SPA Consulting Engineers (SLE) Pty Ltd ABN: 91 510 844 418</p> | TRENCH SECTIONS-LEGEND | | LEGEND | | Substation <input checked="" type="checkbox"/> SUBSTATION <input checked="" type="checkbox"/> RING MAIN UNIT <input checked="" type="checkbox"/> CROSS ROAD PILLAR <input checked="" type="checkbox"/> LINKING PILLAR <input checked="" type="checkbox"/> LIGHTING PIT <input checked="" type="checkbox"/> CABLE JOINT | | Pillars <input checked="" type="checkbox"/> N1, N2, N3, CIA1 & CIA2 PILLARS <input checked="" type="checkbox"/> DISTRIBUTION CABINET <input checked="" type="checkbox"/> STREETLIGHT <input checked="" type="checkbox"/> EARTH <input checked="" type="checkbox"/> HV/LV POLE <input checked="" type="checkbox"/> HV POLE <input checked="" type="checkbox"/> LV POLE <input checked="" type="checkbox"/> POLE MOUNTED TRANSFORMER | | Drawing Title EAST POINT STAGE 1D & 1R-2 UDC UG ELECTRICAL RETICULATION CONSTRUCTION SCHEDULES AND DETAILS | | Date | DECEMBER 2024 | |
| pO BOX 197 WYNNUM, QLD 4178. Ph. (07) 3906 7444 Fax | | | <input checked="" type="checkbox"/> SPARE HV CONDUIT - EXISTING <input checked="" type="checkbox"/> SPARE HV CONDUIT - PLANNED <input checked="" type="checkbox"/> CABLE - PLANNED <input checked="" type="checkbox"/> CABLE - EXISTING <input checked="" type="checkbox"/> CONDUITS - EXISTING <input checked="" type="checkbox"/> CONDUITS - PLANNED | | <input checked="" type="checkbox"/> ZERO LOT BOUNDARY <input checked="" type="checkbox"/> 150mm HV DUCT <input checked="" type="checkbox"/> 125mm HV DUCT <input checked="" type="checkbox"/> 100mm LV DUCT <input checked="" type="checkbox"/> LIGHTING DUCT <input checked="" type="checkbox"/> 35mm sq ANNEALED BARE COPPER EARTH | | <input checked="" type="checkbox"/> CABLE EXISTING <input checked="" type="checkbox"/> CABLE PLANNED <input checked="" type="checkbox"/> CABLE RECOVER <input checked="" type="checkbox"/> EQUIPMENT EXISTING <input checked="" type="checkbox"/> EQUIPMENT RECOVER <input checked="" type="checkbox"/> EQUIPMENT PLANNED | | Project Description EAST POINT SUBDIVISION MACKAY, QLD 4740 | | ERGON Project Number | SPA Drawing Number | Revision | 1960039 | 4003-E04 |